

# CKD FRL Basic Components Chart

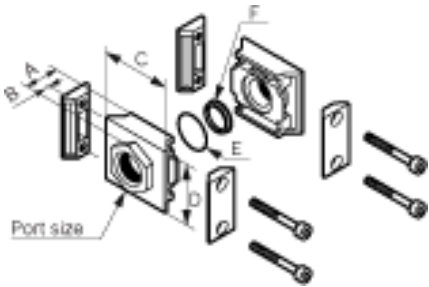

**A400 Straight End Plate Kit**

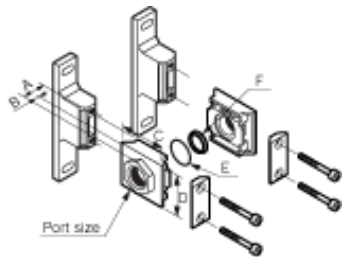

**A400-\*-B41 Straight end Plate Kit**

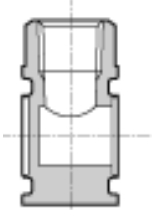

**Filter**

**A401-\*-B41 90° angle entry end port**

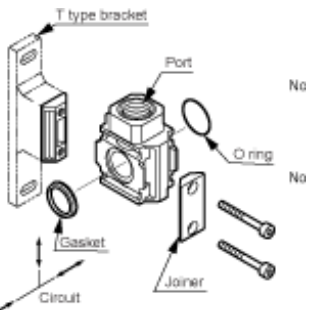

**D401 Distributor Block**



**V3000 or V3301 Shut Off**

OR



**Shut Off Valve**



**Regulator**

Add after the port code for:  
 Nothing = Rpt or BSPT ports  
 "N" = NPT ports  
 "G" = BSPP ports  
 Example:  
 F4000-10-W 3/8 Rpt Filter  
 F4000-10N-W 3/8" NPT Filter  
 F4000-10G-W 3/8 BSPP Filter

## 4000 Series Components Options

A400-(8,10,15,20,25)-W end plate port set (1/4, 3/8, 1/2, 3/4, 1 ports)

\***B410-W Wall mount Joiner Plate**

\***C4000-J400-W Plain Joiner plate**

\***D401-00-(8,10,15)-W-B41W 1/4, 3/8, 1/2 RPT Dist Block**

V3000-(8,10,15)-W Rpt Manual shut off valve(1/4, 3/8, or 1/2 ports)

OR

V3301-(08, 10, 15)-LS-3-S (3 = 24VDC, 4 = 12VDC, 5 = 110 VAC)

Solenoid shut off Valve ( 1/4, 3/8, or 1/2 ports)

\***B410-W Wall mount Joiner Plate**

\***C4000-J400-W Plain Joiner plate**

\***D401-00-(8,10,15)-W-B41W 1/4, 3/8, 1/2 RPT Dist Block**

F4000-(8,10, 15)-W Filter(1/4, 3/8, or 1/2 ports)

\***B410-W Wall mount Joiner Plate**

\***C4000-J400-W Plain Joiner plate**

\***D401-00-(8,10,15)-W-B41W 1/4, 3/8, 1/2 RPT Dist Block**

R4000-(8,10,15)-W Regulator (1/4, 3/8, or 1/2 ports)

\***B410-W Wall mount Joiner Plate**

\***C4000-J400-W Plain Joiner plate**

\***D401-00-(8,10,15)-W-B41W 1/4, 3/8, 1/2 RPT Dist Block**

L4000-(8,10,15)-W Lubricator(1/4, 3/8, or 1/2 ports)

\***B410-W Wall mount Joiner Plate**

\***C4000-J400-W Plain Joiner plate**

\***D401-00-(8,10,15)-W-B41W 1/4, 3/8, 1/2 RPT Dist Block**

A400-(8,10,15,20,25)-W end plate port set (1/4, 3/8, 1/2, 3/4, 1 ports,

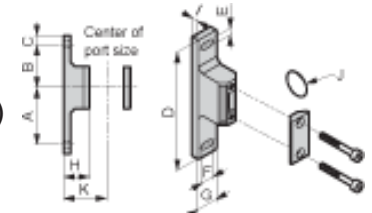

**B410-W**

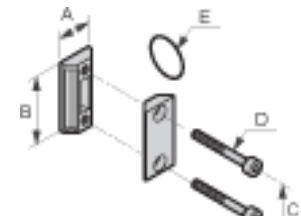

**C4000-J400-W**

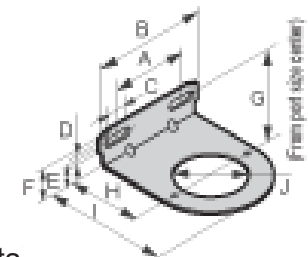

**B430**

\* = select option for this station



Lockout valve (OSHA compliant) Standard white series

# V3010-W/V6010-W Series

Prevent accidents caused by residual pressure.

Port size: 1/4 to 1

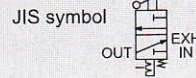

## Specifications

Descriptions		V3010-8-W	V3010-10-W	V3010-15-W	V6010-20-W	V6010-25-W
Working fluid		Compressed air				
Max. working pressure MPa		1				
Withstanding pressure MPa		1.5				
Fluid temperature °C		5 to 60				
Operation lever switching angle		90°				
Operating force	Pushing force N	80 or less				
	Torque N·m	2.5 or less				
Valve seat leakage	cm <sup>3</sup> /min (ANR)	10 or less				
External leakage	cm <sup>3</sup> /min (ANR)	10 or less				
Port size	IN-OUT	1/4	3/8	1/2	Rc 3/4	Rc1
	(Rc, NPT, G) EXH				Rc1/2	
Product weight	kg	0.3			0.8	
Effective sectional area(mm <sup>2</sup> )	IN→OUT	40	70	85	145	150
	OUT→EXH	40	50	50	105	110

OSHA (Occupational Safety and Health Administration)

Standards for worker safety set by the United States.

<Lockout-Tagout>

When servicing or maintaining machinery, the air source shall be closed with a shut-off valve (lockout valve), and residual pressure shall be discharged. If a third party inadvertently operates the valve during such operation and compressed air is applied, the cylinder, etc., could move suddenly and injure personnel. This standard states that, "All valves used for such purposes shall have a key or a structure which can be locked with a key."

## How to order

● FRL 2000, 4000 Series

V3010-8-W- - - - - (A8W)

● For FRL 6000, 8000 Series

V6010-20-W- - - - - (A20W)  
(White type)

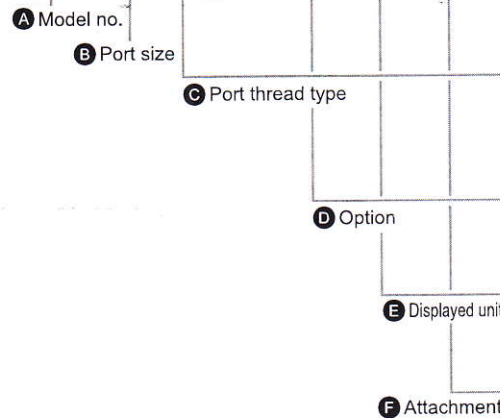

## ⚠ Cautions for model No. selection

Note 1: The piping adapter set and C bracket cannot be used together.

Note 2: A joiner set is attached with the piping adapter set.

⚠ Select the reverse regulator (R\*100-W) or reverse filter regulator (W\*100-W) when installing the V\*010-W onto the primary side of the regulator or filter regulator.

Specification for LiB production (Catalog No. CC-947A)

● Design applicable for LiB manufacturing process

V3010 - ..... - P4\*

## How to use

● Regular use



● Maintenance work

It can be locked at the position where residual pressure is released.

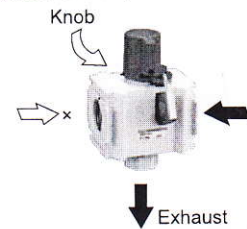

		A Model no.	
		V3010	V6010
Symbol	Descriptions	0	0
B Port size			
8	1/4	●	
10	3/8	●	
15	1/2	●	
20	3/4		●
25	1		●
C Port thread type			
Blank	Rc thread	●	●
N	NPT thread	●	●
G	G thread	●	●
D Option			
Blank	None	●	●
X1	IN/out reverse flow (right to left)	●	●
E Displayed unit			
Blank	MPa display, Rc thread	●	●
J1	MPa display, NPT, G thread	●	●
F Attachment Note 1, Note 2			
Blank	No attachments	●	●
A8W	1/4 piping adaptor set	●	
A10W	3/8 piping adaptor set	●	
A15W	1/2 piping adaptor set	●	
A20W	3/4 piping adaptor set	●	●
A25W	1 piping adaptor set	●	●
A32W	1 1/4 piping adaptor set		●
BW	C type bracket	●	●
S	Silencer	●	●
* Adaptor thread type			
Blank	Rc thread	●	●
N	NPT thread	●	●
G	G thread	●	●



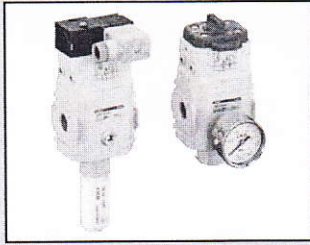

Slow start valve standard white series

# V3301-W/V3321-W Series

Securing safety at starts and stops.

● Port size: Rc1/4 to Rc1/2

JIS symbol

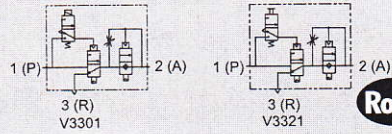

## Specifications

Descriptions		V3301-W/V3321-W		
Operating method		Pilot operated soft spool valve		
Working fluid		Compressed air (excluding super dry air) Note 1		
Working pressure range MPa		0.2 to 1.0		
Withstanding pressure MPa		1.5		
Ambient temperature range °C		5 to 60		
Port size	1 (P), 2 (A) port	Rc1/4	Rc3/8	Rc1/2
	3 (R) port	Rc3/8		
	Gauge port	Rc1/4		
Effective sectional area mm <sup>2</sup>	Low speed intake	6		
	High speed intake	40	64	76
	High speed exhaust	50	74	78
Response time		0.2sec or less		
Lubrication		Oil-free Note 2		
Weight g		V3301-W: 635 V3321-W: 515		
Solenoid valve specification		V3301-W		
Rated voltage V		AC100 (50/60Hz)	AC200 (50/60Hz)	DC24
Starting current A		0.076/0.058	0.038/0.030	0.092
Holding current A		0.038/0.029	0.019/0.015	
Power consumption W		2.2/1.7	2.2/1.7	2.2
Temperature increase K		40 or less		
Voltage fluctuation range		±10%		
Insulation class		B class		
Electric connection		Grommet lead wire, terminal box		

Note 1: Contact CKD when using ultra dry compressed air.  
 Note 2: Use the turbine oil Class 1 ISO VG32 if lubricated.

## How to order

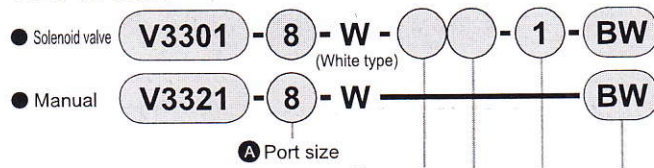

**C** Electric connection

**D** Voltage

**E** Attachment

⚠ Select the reverse regulator (R\*100-W) or reverse filter regulator (W\*100-W) when installing the V3301-W or V3321-W onto the primary side of the regulator or filter regulator.

Specification for LiB production

(Catalog No. CC-947A)

● Specification for LiB manufacturing process

**V3301** - ..... - **P4\***

Symbol	Descriptions	
<b>A</b>	<b>Port size</b>	
	<b>1 (P), 2 (A) port</b>	
<b>08</b>	Rc1/4	
<b>10</b>	Rc3/8	
<b>15</b>	Rc1/2	
<b>B</b>	<b>Manual override</b>	
<b>Blank</b>	Non-locking type	
<b>M1</b>	Locking type	
<b>C</b>	<b>Electric connection</b>	
<b>Blank</b>	Grommet lead wire	
<b>S</b>	Grommet lead wire with surge suppressor	
<b>B</b>	Terminal box	
<b>LS</b>	Terminal box surge suppressor with lamp	
<b>D</b>	<b>Voltage</b>	
<b>1</b>	AC100V 50/60Hz	Standard
<b>2</b>	AC200V 50/60Hz	
<b>3</b>	DC24V	Option
<b>4</b>	DC12V	
<b>5</b>	AC110V 50/60Hz	
<b>6</b>	AC220V 50/60Hz	
<b>E</b>	<b>Attachment</b>	
<b>Blank</b>	No attachments	
<b>BW</b>	C type bracket	
<b>G49P</b>	Pressure gauge: G49D-8-P10	
<b>S</b>	Silencer	



# Air Filter Series

How to order

## How to order

**F1000** - **6** - **W** - **Z** - **A6W**

Ⓐ Model no.

Ⓑ Port size

Ⓒ Port thread type

Ⓓ Option

Ⓔ Displayed unit

Ⓕ Piping adaptor set (included)

Ⓖ Bracket (attached)

\* Refer page 9 for an explanation of the options.

Ⓐ Model no.					
F	F	F	F	F	F
1	2	3	4	6	8
0	0	0	0	0	0
0	0	0	0	0	0
0	0	0	0	0	0

Symbol	Descriptions						
<b>Ⓑ Port size</b>							
6	1/8	●					
8	1/4	●	●	●	●		
10	3/8		●	●	●		
15	1/2			●			
20	3/4					●	●
25	1					●	●
<b>Ⓒ Port thread type</b>		<b>Note 1</b>					
Blank	Rc thread	●	●	●	●	●	●
N	NPT thread	●	●	●	●	●	●
G	G thread	●	●	●	●	●	●
<b>Ⓓ Option</b>		<b>Note 2</b>					
Drainage	Blank	With manual drain cock	●	●	●	●	●
	F	Automatic drain with manual override (NO type)			●	●	●
	F1	Automatic drain with manual override (NC type)	●	●	●	●	●
	FF	Large exhaust automatic drain with manual override (NO type)					●
	FF1	Large exhaust automatic drain with manual override (NO type)					●
Bowl material	Blank	Polycarbonate bowl	●	●	●	●	●
	Z	Nylon bowl	●	●	●	●	●
	M	Metal bowl			●	●	●
	M1	Metal bowl with manual drain cock			●	●	●
Element	Blank	5µm	●	●	●	●	●
	Y	0.3µm (submicron)			●	●	●
Differential pressure detection	Blank	Without differential pressure detection port	●	●	●	●	●
	Q	With differential pressure detection port (Rc1/4)				●	●
Flow Direction	Blank	Standard flow (left to right)	●	●	●	●	●
	X1	Reverse flow (right to left)	●	●	●	●	●
<b>Ⓔ Displayed unit</b>							
Blank	MPa display, Rc thread	●	●	●	●	●	●
J1	MPa display, NPT, G thread	●	●	●	●	●	●
<b>Ⓕ Piping adaptor set (included)</b>		<b>Note 4 pages 155 to 157 Note 5</b>					
Blank	Not attached	●	●	●	●	●	●
A6*W	1/8 piping adaptor set	●					
A8*W	1/4 piping adaptor set	●	●	●	●		
A10*W	3/8 piping adaptor set	●	●	●	●		
A15*W	1/2 piping adaptor set		●	●	●		
A20*W	3/4 piping adaptor set				●	●	●
A25*W	1 piping adaptor set					●	●
A32*W	1 1/4 piping adaptor set					●	●
<b>* Adaptor thread type</b>							
Blank	Rc thread	●	●	●	●	●	●
N	NPT thread	●	●	●	●	●	●
G	G thread	●	●	●	●	●	●
<b>Ⓖ Bracket (attached)</b>		<b>Page 152</b>					
Blank	Not attached	●	●	●	●	●	●
BW	C type bracket	●	●	●	●	●	●

### ⚠ Cautions for model No. selection

Note 1: When G threads or NPT threads are selected, the IN, OUT, gauge port, and drainage discharge port (metal bowl automatic drain) are the target, as are attachments P and V.

Note 2: Select the option from drain exhaust, bowl material and differential pressure detection. When selecting options for several items, list options in order from the top.

Note 3: Refer to page 12 for working conditions of the automatic drain.

Note 4: The piping adapter set and C bracket cannot be used together.

Note 5: A joiner set is attached with the piping adapter set.



# Regulator Series

How to order

How to order

\* Refer top page 9 for an explanation of the options.



A Model no.

B Port size

C Port thread type

D Option

E Displayed unit

G Attachment

F Piping adaptor set (included)

A Model no.					
R	R	R	R	R	R
1	2	3	4	6	8
0	0	0	0	0	0
0	0	0	0	0	0
0	0	0	0	0	0

Symbol	Descriptions						
<b>B Port size</b>							
6	1/8	●					
8	1/4	●	●	●	●		
10	3/8		●	●	●		
15	1/2				●		
20	3/4					●	●
25	1					●	●

<b>C Port thread type</b>		Note 1					
Blank	Rc thread	●	●	●	●	●	●
N	NPT thread	●	●	●	●	●	●
G	G thread	●	●	●	●	●	●

<b>D Option</b>		Note 2					
Pressure Range	Blank	0.05 to 0.85MPa	●	●	●	●	●
	L	0.05 to 0.35MPa Note 3	●	●	●	●	●
Relief	Blank	With relief mechanism	●	●	●	●	●
	N	Non-relief type	●	●	●	●	●
Pressure gauge	Blank	Standard pressure gauge (G401-W)	●	●	●	●	●
	T	Without pressure gauge (gauge port (Rc1/4) assembled sealed)	●	●	●	●	●
	T8	Pressure gauge attachable (gauge port (Rc1/4) assembled open)	●	●	●	●	●
	T6	Compatibility with digital pressure sensor PPX Note 4	●	●	●	●	●
Flow Direction	Blank	Standard flow (left to right)	●	●	●	●	●
	X1	Reverse flow (right to left)	●	●	●	●	●

<b>E Displayed unit</b>							
Blank	MPa display, Rc thread	●	●	●	●	●	●
J1	MPa display, NPT, G thread	●	●	●	●	●	●

<b>F Piping adaptor set (included)</b>		Note 6, 7 pages 155 to 157					
Blank	Not attached	●	●	●	●	●	●
A6*W	1/8 piping adaptor set	●					
A8*W	1/4 piping adaptor set	●	●	●	●		
A10*W	3/8 piping adaptor set	●	●	●	●		
A15*W	1/2 piping adaptor set		●	●	●		
A20*W	3/4 piping adaptor set				●	●	●
A25*W	1 piping adaptor set					●	●
A32*W	1 1/4 piping adaptor set					●	●

<b>* Adaptor thread type</b>							
Blank	Rc thread	●	●	●	●	●	●
N	NPT thread	●	●	●	●	●	●
G	G thread	●	●	●	●	●	●

<b>G Attachment</b>		Note 8 Page 152, 198					
Blank	Not attached	●	●	●	●	●	●
BW	C type bracket	●	●	●	●	●	●
B3W Note 5	L type bracket Note 9	●	●	●	●	●	
B4W	B type bracket		●				
G45P	G45D-8-P10 (L: G45D-8-P04)	●	●	●	●	●	●
G49P	G49D-8-P10 (L: G49D-8-P04)	●	●	●	●	●	●
G59P	G59D-8-P10 (L: G59D-8-P04)	●	●	●	●	●	●
G40P	G40D-8-P10 (L: G40D-8-P04)	●	●	●	●	●	●
G50P	G50D-8-P10 (L: G50D-8-P04)	●	●	●	●	●	●
G41P	G41D-8-P10 (L: G41D-8-P04)	●	●	●	●	●	●
G52P	G52D-8-P10 (L: G52D-8-P10)	●	●	●	●	●	●
R2 Note 4	Digital pressure sensor: PPX-R10N-6M	●	●	●	●	●	●

## ⚠ Cautions for model No. selection

- Note 1: G and NPT threads are available for IN, OUT, and gauge ports.
- Note 2: When selecting options for several items, list options in order from the top.
- Note 3: Pressure gauge display range will be 0 to 0.4 MPa for option "L".
- Note 4: When option "T6" is selected, only "blank" or "R2" is selected for the (G) pressure gauge (enclosed). The digital pressure sensor PPX mounting port (Rc1/8) is assembled ventilated.
- Note 5: Output type will be NPN transistor output. Consult with CKD if PNP transistor output is required.
- Note 6: The piping adapter set and C bracket cannot be used together.
- Note 7: A joiner set is attached with the piping adapter set.
- Note 8: If NPT is selected for the "C" piping thread type, a NPT pressure gauge is enclosed. If Rc or G thread is selected, an R thread pressure gauge is enclosed.
- Note 9: Refer to Section 2, Regulator, in "⚠ PRECAUTIONS for Installation and Adjustment" (page 15) for details on mounting the L-type bracket.



# Lubricator Series

How to order

How to order



\* Refer top page 9 for an explanation of the options.

A Model no.			
L	L	L	L
1	3	4	8
0	0	0	0
0	0	0	0
0	0	0	0

A Model no.

B Port size

C Port thread type

D Option

E Displayed unit

F Piping adaptor set (included)

G Bracket (attached)

Symbol	Descriptions				
<b>B Port size</b>					
6	1/8	●			
8	1/4	●	●	●	
10	3/8		●	●	
15	1/2			●	
20	3/4				●
25	1				●

C Port thread type		Note 1			
Blank	Rc thread	●	●	●	●
N	NPT thread	●	●	●	●
G	G thread	●	●	●	●

D Option			Note 2			
Drain Discharge	Blank	No manual cock	●	●	●	●
	C	With manual cock	●	●	●	●
	LL	With float switch		●	●	●
Bowl Material	Blank	Polycarbonate bowl	●	●	●	●
	Z	Nylon bowl	●	●	●	●
	M	Metal bowl		●	●	●
Note 3	M1	Metal bowl with manual drain cock Note 4		●	●	●
Flow Direction	Blank	Standard flow (left to right)	●	●	●	●
	X1	Reverse flow (right to left)	●	●	●	●

E Displayed unit					
Blank	MPa display, Rc thread	●	●	●	●
J1	MPa display, NPT, G thread	●	●	●	●

F Piping adaptor set (included)		Note 5, 6 pages 155 to 157			
Blank	Not attached	●	●	●	●
A6*W	1/8 piping adaptor set	●			
A8*W	1/4 piping adaptor set	●	●	●	
A10*W	3/8 piping adaptor set	●	●	●	
A15*W	1/2 piping adaptor set		●	●	
A20*W	3/4 piping adaptor set			●	●
A25*W	1 piping adaptor set				●
A32*W	1 1/4 piping adaptor set				●

* Adaptor thread type					
Blank	RC thread	●	●	●	●
N	NPT thread	●	●	●	●
G	G thread	●	●	●	●

G Bracket (attached)					
Blank	Not attached	●	●	●	●
BW	C type bracket	●	●	●	●

## ⚠ Cautions for model No. selection

Note 1: G and NPT threads are available for IN, OUT.

Note 2: When selecting options for several items, list options in order from the top.

Note 3: The adjusting dome is made of polycarbonate for a nylon bowl or metal bowl. Consult with CKD if a different material is required.

Note 4: Have a choice drain discharge option "C" or "F" and "F1" for option "M1".

Note 5: The piping adapter set and C bracket cannot be used together.

Note 6: A joiner set is attached with the piping adapter set.

Drainage and bowl material combination (how to order "D")

Option ● with float switch

3000/4000/8000 Series			
Shape			
Material	Plastic bowl		Metal bowl
	Polycarbonate	Nylon	Aluminum
Lubricator L:000-W	LL	LLZ	LLM



# Filter·Regulator Series

How to order

How to order

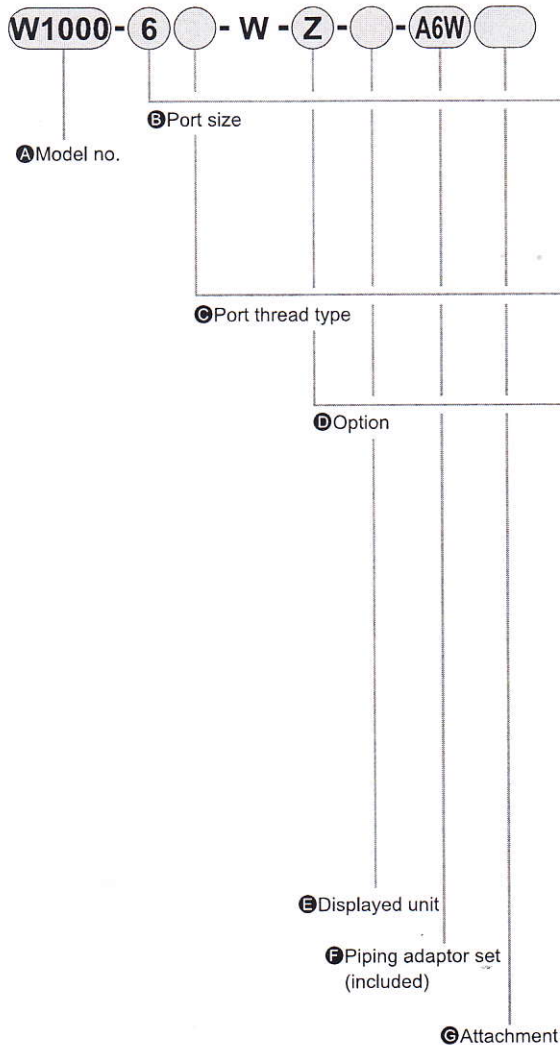

\* Refer page 9 for an explanation of the options.

A Model no.				
W	W	W	W	W
1	2	3	4	8
0	0	0	0	0
0	0	0	0	0
0	0	0	0	0

Symbol	Descriptions					
<b>B Port size</b>						
6	1/8	●	●	●	●	●
8	1/4	●	●	●	●	●
10	3/8	●	●	●	●	●
15	1/2	●	●	●	●	●
20	3/4	●	●	●	●	●
25	1	●	●	●	●	●

<b>C Port thread type</b>		Note 1				
Blank	Rc thread	●	●	●	●	●
N	NPT thread	●	●	●	●	●
G	G thread	●	●	●	●	●

<b>D Option</b>		Note 2				
Drainage	Blank	With manual drain cock	●	●	●	●
	F	Automatic drain with manual override (NO type)	●	●	●	●
	F1	Automatic drain with manual override (NC type)	●	●	●	●
	FF	Large exhaust automatic drain with manual override (NO type)	●	●	●	●
Note 3	FF1	Large exhaust automatic drain with manual override (NO type)	●	●	●	●
	Blank	Polycarbonate bowl	●	●	●	●
Bowl material	Z	Nylon bowl	●	●	●	●
	M	Metal bowl	●	●	●	●
	M1	Metal bowl with manual drain cock	●	●	●	●
Element	Blank	5μm	●	●	●	●
	Y	0.3μm (submicron) Note 4	●	●	●	●
Pressure Range	Blank	0.05 to 0.85MPa	●	●	●	●
	L	0.05 to 0.35MPa Note 5	●	●	●	●
Relief	Blank	With relief mechanism	●	●	●	●
	N	Non-relief type	●	●	●	●
Pressure gauge	Blank	Standard pressure gauge (G401-W)	●	●	●	●
	T	Without pressure gauge (gauge port (Rc1/4) assembled sealed)	●	●	●	●
	T8	Pressure gauge attachable (gauge port (Rc1/4) assembled open)	●	●	●	●
	T6	Compatibility with digital pressure sensor PPX Note 6	●	●	●	●
Flow Direction	R1	Pressure switch with display PPD assembled Note 7	●	●	●	●
	Blank	Standard flow (left to right)	●	●	●	●
X1	Reverse flow (right to left)	●	●	●	●	

<b>E Displayed unit</b>						
Blank	MPa display, Rc thread	●	●	●	●	●
J1	MPa display, NPT, G thread	●	●	●	●	●

<b>F Piping adaptor set (included)</b>		Note 8, 9 Pages 155 to 157				
Blank	Not attached	●	●	●	●	●
A6*W	1/8 piping adaptor set	●	●	●	●	●
A8*W	1/4 piping adaptor set	●	●	●	●	●
A10*W	3/8 piping adaptor set	●	●	●	●	●
A15*W	1/2 piping adaptor set	●	●	●	●	●
A20*W	3/4 piping adaptor set	●	●	●	●	●
A25*W	1 piping adaptor set	●	●	●	●	●
A32*W	1 1/4 piping adaptor set	●	●	●	●	●

<b>* Adaptor thread type</b>						
Blank	Rc thread	●	●	●	●	●
N	NPT thread	●	●	●	●	●
G	G thread	●	●	●	●	●

<b>G Attachment</b>		Note 10 Page 152, 198				
Blank	Not attached	●	●	●	●	●
BW	C type bracket	●	●	●	●	●
B3W Note 7	L type bracket Note 11	●	●	●	●	●
G45P	G45D-8-P10 (L: G45D-8-P04)	●	●	●	●	●
G49P	G49D-8-P10 (L: G49D-8-P04)	●	●	●	●	●
G59P	G59D-8-P10 (L: G59D-8-P04)	●	●	●	●	●
G40P	G40D-8-P10 (L: G40D-8-P04)	●	●	●	●	●
G50P	G50D-8-P10 (L: G50D-8-P04)	●	●	●	●	●
G41P	G41D-8-P10 (L: G41D-8-P04)	●	●	●	●	●
G52P	G52D-8-P10 (L: G52D-8-P10)	●	●	●	●	●
R2 Note 5	Digital pressure sensor: PPX-R10N-6M	●	●	●	●	●

## ⚠ Cautions for model No. selection

- Note 1: G threads and NPT threads are available for IN, OUT, gauge port and drain discharge port (metal bowl with automatic drain).
- Note 2: Select options per drainage, bowl material, element, and regulator sections. When selecting options for several items, list options in order from the top.
- Note 3: Refer to page 12 for working conditions of the automatic drain.
- Note 4: Refer to page 87 for max. flow rate of option "Y".
- Note 5: Pressure gauge display range will be 0 to 0.4 MPa for option "L".
- Note 6: When option "T6" is selected, only "blank" or "R2" is selected for the (G) pressure gauge (enclosed). The digital pressure sensor PPX mounting port (Rc1/8) is assembled ventilated.
- Note 7: Out put type will be NPN transistor output. Consult with CKD if PNP transistor output is required.
- Note 8: Piping adapter set and C bracket cannot be used together.
- Note 9: A joiner set is attached with the piping adapter set.
- Note 10: If NPT is selected for the "C" piping thread type, a NPT pressure gauge is enclosed. If Rc or G thread is selected, an R thread pressure gauge is enclosed.
- Note 11: Refer to Section(2. Regulator), in "⚠ PRECAUTIONS For Installation and Adjustment" (page 15) for details on mounting the L-type bracket.



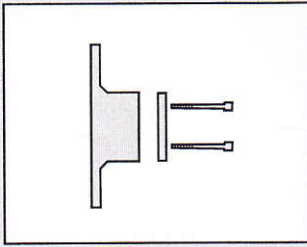

Bracket Standard white series

# B-W/B Series

Joiner Standard white series

# J-W Series



## Dimensions and applications

### T type bracket set

- Model no.: B110-W·B310-W·B410-W·B810-W
- Applications

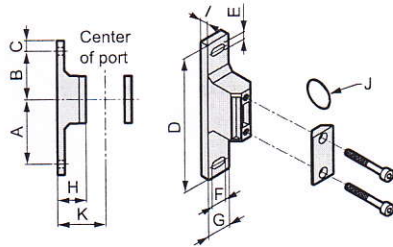

Note: Select B410-W when using the 3000-W Series and 4000-W Series combined.

Model no.	Applicable model	A	B	C*	D	E	F	G	H	I	J	K
B110-W	1000 Series	45	35	10	100	5.5	7.5	16	25	7.5	JASO-2013	40
B310-W	2000 Series	60	45	10	125	7	14	22	27	7	JISB2401-P21	45
	3000 Series											
B410-W	4000 Series	60	45	10	125	7	14	22	37	7	JISB2401-P21	55
B810-W	6000 Series	70	50	15	150	9	14	27	37	8	AS568-127	65
	8000 Series											

### C type bracket

- Model no.: B120·B220·B320·B420·B620·B820
- Attachment: BW

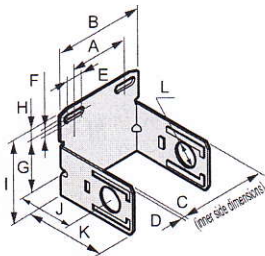

- Applications



Model no.	Applicable model	A	B	C	D	E	F	G	H	I	J	K	L
B120	1000 Series	44	68	40	t2.0	10	6.5	35	8.5	61.5	40	60	ø19.5
B220	2000 Series	28	54	50	t2.3	10	7	33	8	63	45	69	17.3
B320	3000 Series	34.5	67	63	t2.3	16.5	7	45	9	75.5	45	69	ø21.7
B420	4000 Series	55	84	80	t2.3	14.0	7	45	9	75.5	55	79	ø21.7
B620	6000 Series	68	104	90	t2.3	16	9	54	11	97.5	60	97	ø35
B820	8000 Series	68	104	100	t2.3	16	9	50	11	93.5	65	102	ø35

### L type bracket

- Model no.: B130·B230·B330·B430
- Attachment: B3W

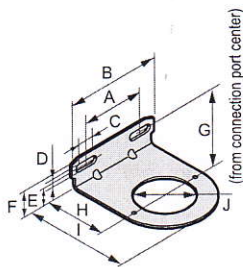

- Applications



Loosen the mounting nut to remove the knob. After inserting L type bracket, fix the bracket by the mounting nut. Press the knob in manually after fixing.

Refer to page 15 for the details.

Model no.	Applicable model	A	B	C	D	E	F	G	H	I	J	Other
B130	1000 Series	44	68	10	6.5	16	24.5	45	40	59	ø26.5	
B230	2000 Series	28	54	10	7	18	26	52	45	69	38	
B330	3000 Series	34.5	67	16.5	7	17.5	26	58 (63.5)	45	76	ø40	Values ( ) are for W3000·3100
B430	4000 Series 6000 Series	55	84	14	7	17.5	26	58	55	94	ø47	

### Joiner set

- Model no.: C1000-J100-W  
C4000-J400-W  
C8000-J800-W

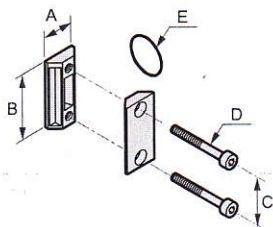

- Applications



Model no.	Applicable model	A	B	C	D	E
C1000-J100-W	1000 Series	10	36	26	M3.5	JASO-2013
C4000-J400-W	2000 Series	21	44	32	M5	JIS B2401-P21
	3000 Series					
	4000 Series					
C8000-J800-W	6000 Series	26	65	50	M6	AS568-127
	8000 Series					



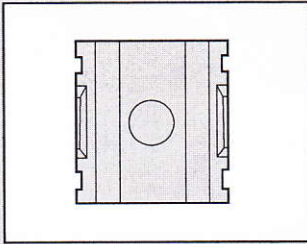

Distributor Standard white series

# D101/D401/D801/D300-W Series

Applicable for pipe branching.

Port size: 1/8 to 1

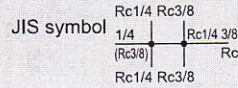

## Specifications

Descriptions	D101-00-W	D401-00-W	D801-00-W	D300-W
Working fluid	Compressed air			
Max. working pressure MPa	1.0			
Withstanding pressure MPa	1.5			
No. of branch ports	1			4
Port size Rc, PT,	1/8, 1/4	1/4, 3/8, 1/2	3/4, 1	1/4, 3/8
Working temperature °C	5 to 60			
Product weight kg	0.045	0.13	0.35	0.26

## How to order

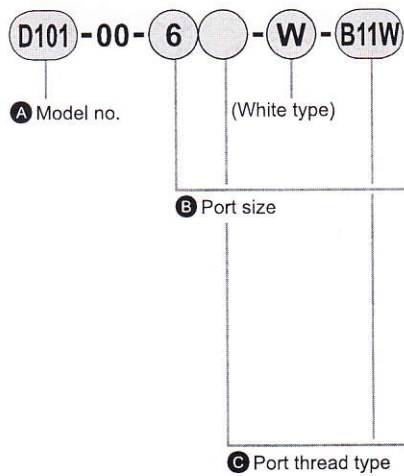

Symbol	Descriptions
<b>A Model no.</b>	
D101	For 1000 Series
D401	For 2000, 3000, 4000 Series
D801	For 6000, 8000 Series
<b>B Port size</b>	
	D101 D401 D801
6 1/8	●
8 1/4	● ●
10 3/8	● ●
15 1/2	● ●
20 3/4	● ●
25 1	● ●
<b>C Port thread type</b>	
Blank	Rc thread
N	NPT thread
G	G thread
<b>D T type bracket</b>	
Blank	None
B11W	For 1000 Series
B31W	For 2000 Series
B41W	For 4000 Series
B81W	For 6000 Series

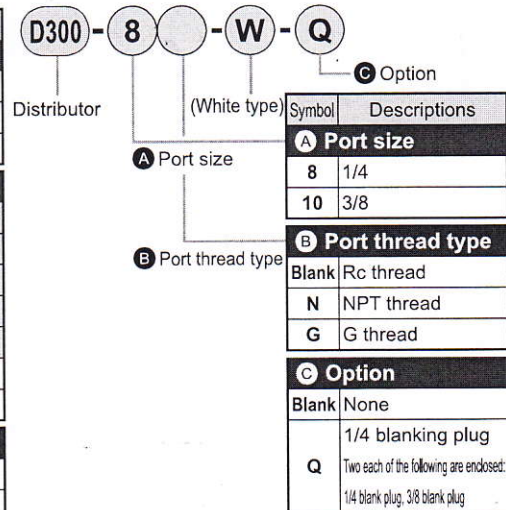

### ⚠ Cautions for model No. selection

- Note 1: A joiner set (joiner/bolt/O-ring) and a gasket are attached as standard.
- Note 2: Consult with CKD for 2 way branch.
- Note 3: D401-W can be connected to both 3000-W and 4000-W series.

### ⚠ Cautions for model No. selection

- Note 1: When using with C3000-W, C4000-W, a joiner set C4000-J400-W, or T type bracket set B310-W or B410-W is required to connect.
- Note 2: Joiner set C4000-J400-W or T type bracket set should be ordered separately. (Refer to page 152)

## How to install (D101-00-W, D401-00-W, D801-00-W)

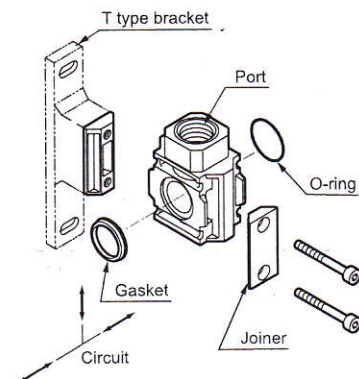

- Note 1: When installing at the primary side, insert an O ring, while installing at the secondary side, insert a gasket.
- Note 2: When inserting O ring and gasket to assemble, O ring and gasket must not be folded.

## Example (D101-00-W, D401-00-W, D801-00-W)

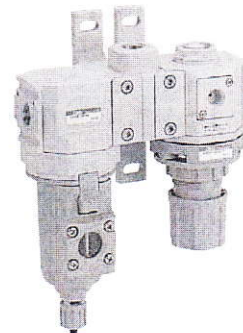



# Distributor

Dimensions

Dimensions



● D101-00-W

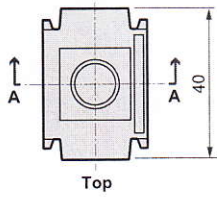

Top

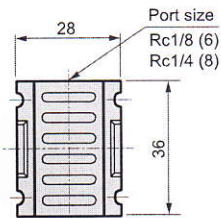

Front

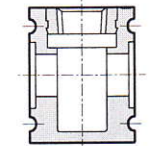

Cross section A-A

● D401-00-W

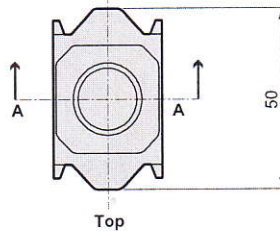

Top

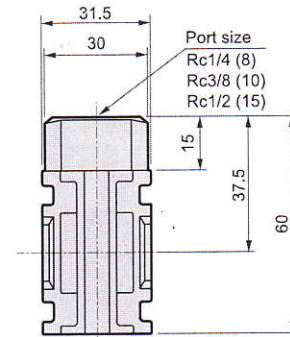

Front

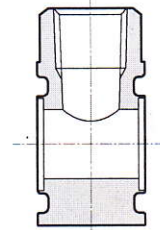

Cross section A-A

● D801-00-W

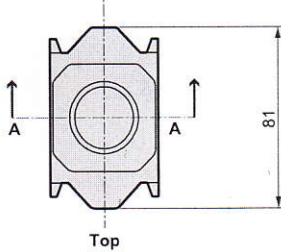

Top

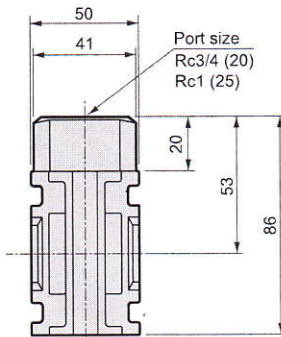

Front

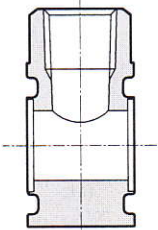

Cross section A-A

● D300-W

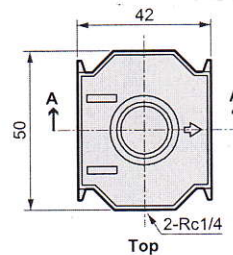

Top

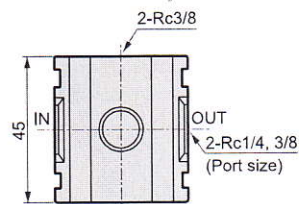

Front

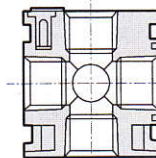

Cross section A-A



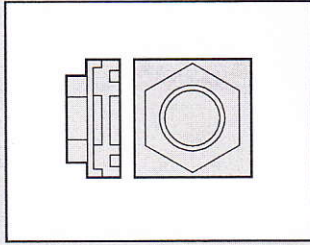

Piping adapter standard white series

# A100 / A400 / A800-W Series

Port size: 1/8 to 1



## Dimensions and applications

### Piping adaptor set

- Model no.: A100-6, 8, 10-W  
A400-8, 10, 15, 20-W  
A800-20, 25, 32-W

#### ● Applications

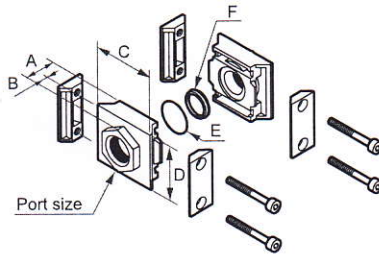
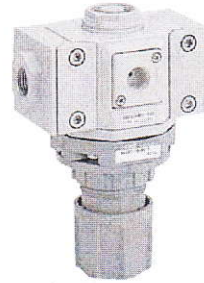

Model no.	Port size	Applicable model	A	B	C	D	E (O-ring)	F (Gasket)	Other
A100-6*-W	1/8	1000 Series	21.5	13.5	40	36	JASO-2013 1 programs	1 programs	-
A100-8*-W	1/4								
A100-10*-W	3/8								
A400-8*-W	1/4	2000 3000 Series	20 (25) {34}	6 (11) {20}	50	45	JISB2401 P21 1 programs	1 programs	Numbers in ( ) are for 3/4 Numbers in { } are for 1
A400-10*-W	3/8								
A400-15*-W	1/2								
A400-20*-W	3/4								
A400-25*-W	1								
A800-20*-W	3/4	6000 8000 Series	35 (38)	15 (18)	81	66	AS568-127 1 programs	1 programs	Numbers in ( ) are for 1 1/4
A800-25*-W	1								
A800-32*-W	1 1/4								

\* Blank: Rc thread/N: NPT thread/G: G thread

### Piping adaptor set with T type bracket

- Model no.: A100-6, 8, 10-W-B11W  
A400-8, 10, 15-W-B31W  
A400-8, 10, 15, 20-W-B41W  
A800-20, 25, 32-W-B81W  
(T type bracket)

#### ● Applications

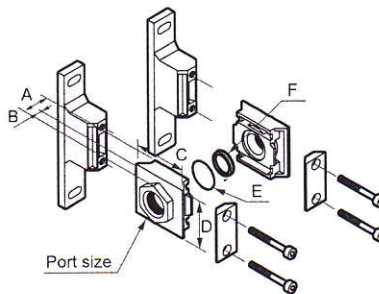

Model no.	Port size	Applicable model	A	B	C	D	E (O-ring)	F (Gasket)	Other
A100-6*-W-B11W	1/8	1000 Series	21.5	13.5	40	36	JASO-2013 1 programs	1 programs	-
A100-8*-W-B11W	1/4								
A100-10*-W-B11W	3/8								
A400-8*-W-B31W	1/4	2000 3000 Series	20	6	50	45	JISB2401 P21 1 programs	1 programs	
A400-10*-W-B31W	3/8								
A400-15*-W-B31W	1/2								
A400-8*-W-B41W	1/4								
A400-10*-W-B41W	3/8								
A400-15*-W-B41W	1/2	4000 Series	20 (25) {34}	6 (11) {20}	50	45	JISB2401 P21 1 programs	1 programs	Numbers in ( ) are for 3/4 Numbers in { } are for 1
A400-20*-W-B41W	3/4								
A400-25*-W-B41W	1								
A800-20*-W-B81W	3/4	6000 8000 Series	35 (38)	15 (18)	81	66	AS568-127 1 programs	1 programs	Numbers in ( ) are for 1 1/4
A800-25*-W-B81W	1								
A800-32*-W-B81W	1 1/4								

\* Blank: Rc thread/N: NPT thread/G: G thread



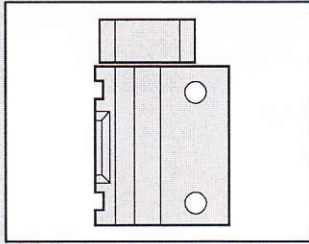

Lpiping adaptor White Series

# A101/A401/A801-W Series

Port size: 1/8 t 1



## Specifications

Descriptions	A101-W	A401-W Note 1	A801-W
Working fluid	Compressed air		
Max. working pressure MPa	1.0		
Withstanding pressure MPa	1.5		
Port size Rc, PT,	1/8, 1/4	1/4, 3/8, 1/2	3/4, 1
Working temperature °C	5 to 60		
Product weight kg	0.045	0.13	0.4

Note 1: A401-W can be connected to both 3000-W Series and 4000-W Series.

## How to order

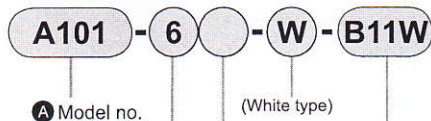

Symbol	Descriptions			
<b>A Model no.</b>				
A101	L type piping adapter			
A401	L type piping adapter			
A801	L type piping adapter			
<b>B Port size</b>				
	A101	A401	A801	
6 1/8	●			
8 1/4	●	●		
10 3/8		●		
15 1/2		●		
20 3/4			●	
25 1			●	
<b>C Port thread type</b>				
Blank	Rc thread			
N	NPT thread			
G	G thread			
<b>D T bracket</b>				
Blank	None Note 1	●	●	●
B11W	For 1000 Series	●		
B31W	For 2000 Series For 3000 Series		●	
B41W	For 4000 Series		●	
B81W	For 6000 Series For 8000 Series			●

B Port size

C Port thread type

D T type bracket

- Applicable models
- A101-6, 8-W  
..... 1000-W Series
  - A401-8, 10, 15-W  
..... 2000, 3000, 4000-W Series
  - A801-20, 25-W  
..... 6000, 8000-W Series

## ⚠ Cautions for model No. selection

Note 1: Joiner set (joiner, bolt, O ring) and 1 gasket included.

## L type piping adapter

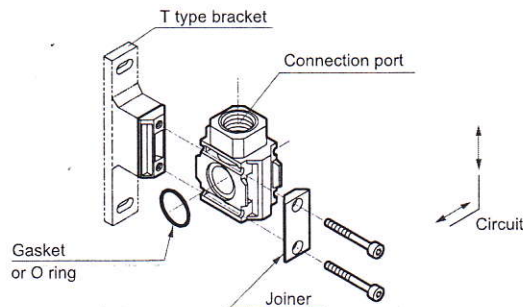

## ● Applications

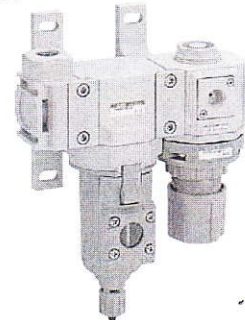

Note: Insert the fitting for replacement vertically until it reaches the back. Insert the O ring when mounting on the primary side for the air flow, and insert the gasket when mounting on the secondary side.

Note: Refer to the next page for dimensions.



# Piping adaptor

Dimensions 

● A101-W

● A401-W

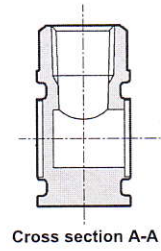
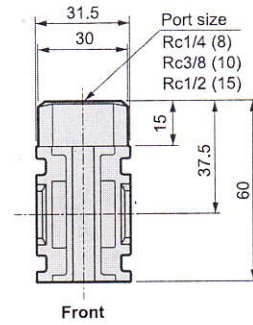
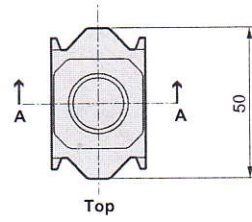
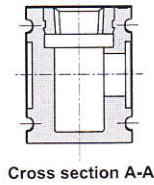
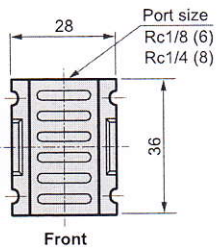
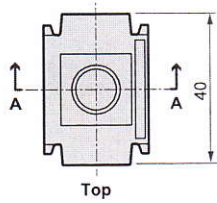

● A801-W

